

INSTALLATION GUIDE

HOSELINK®

Under Tree Sprinkler Irrigation Kit

MODEL: I4003BKKT

For more information visit hoselink.com.au or call 1300 900 617



Kit Contents



1x
Pressure Regulator 175 kPa
Code: I4016BKBS



1x
Nut & Tail 3/4" BSPF x 13mm
Code: I4008BKBS



1x
25m x 13mm Poly Pipe
Code: 19961-013025



5x
Under Tree Sprinkler Spike
Code: I4003BKBS



2x
13mm Tees
Code: I4014BKBS



2x
13mm Joiners
Code: I4012BKBS



2x
13mm End Plugs
Code: I4011BKBS



5x
13mm Elbows
Code: I4013BKBS



8x
Hold Down Stakes
Code: I4017BKBS



23x
13mm Ratchet Clamps
Code: I4009BKBS



1x
Goof Repair Plugs (Rack of 10)
Code: I4006BKBS



1x
Tap Adapter 1"
Code: I4018BKBS

Planning Your Irrigation System

We recommend planning out the desired set up by laying out all necessary pieces (elbows, joiners, Under Tree Sprinkler Spikes etc) before cutting the Poly Pipe. Where possible we advise laying out irrigation in a circuit to ensure even pressure throughout. Example layouts can be found at the end of this manual.

Installing Tap Fittings

- 1 Screw the Pressure Regulator onto a 3/4" thread tap. Use 1" Tap Adapter if needed. The Pressure Regulator is required to create the optimal working pressure for the system and prevent bursts due to high water pressure.
- 2 Make sure the FLOW arrow is pointing in the direction of flow.
- 3 Screw the Nut & Tail onto the bottom of the Pressure Regulator.
- 4 Slide a 13mm Ratchet Clamp over the Poly Pipe.
- 5 Push Poly Pipe over the barbed end of the Nut & Tail, ensuring it is pushed all the way down.
- 6 Slide the Ratchet Clamp over the connection and tighten with fingers to secure.



- Pressure Regulator
- Nut & Tail
- Ratchet Clamp
- 13mm Poly Pipe

Installing Tubing

- 1 Cut 13mm Poly Pipe to required length.

Tip: Roll out Poly Pipe in the sun to soften and straighten it out.

- 2 Use Elbows, Tees, and Joiners to create your desired layout.

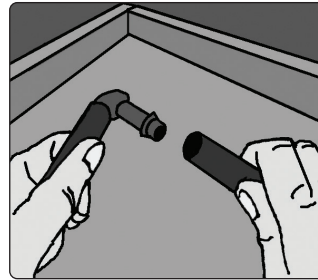

- 3 Place 13mm Ratchet Clamps over the Poly Pipe before attaching the barbed fittings. Push barbed fittings into the 13mm Poly Pipe, securing each end of the fittings with a 13mm Ratchet Clamp. Repeat until all fittings are attached.

Tip: If you are running a circuit leave one barbed fitting disconnected for now, so you can flush the system before use.



- 4 Once all Elbow, Tee and Joiners are connected, use the Hold-Down Stakes to secure the 13mm Poly Pipe to the ground.

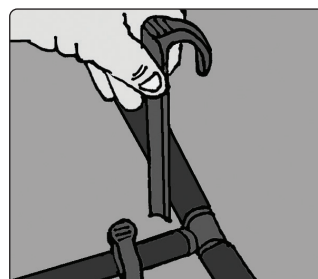

Installing Emitters

- 1 Decide Under Tree Sprinkler Spike locations and push the adaptor directly into the 13mm Poly Pipe.

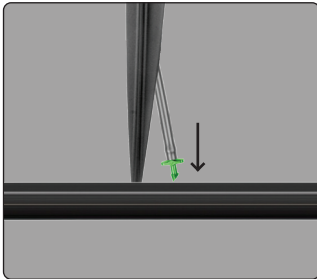

If you are having trouble pushing adaptor into the 13mm Poly Pipe, use the end of the Sprinkler Spike to create a hole.

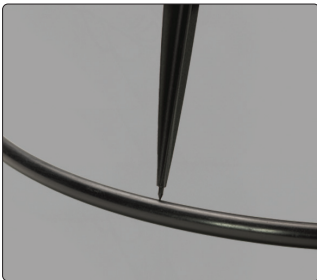

Tip: Incorrect holes can be repaired with Goof Plugs.

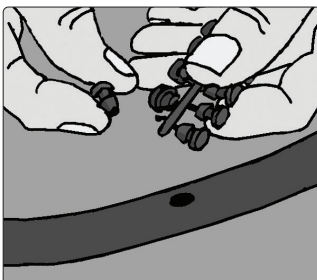

Using Your System

- 1 Once all Under Tree Sprinkler Spikes are installed, flush the 13mm Poly Pipe and then seal the ends with End Plugs. Secure with 13mm Ratchet Clamps.

If running a circuit, connect the remaining barbed fitting and secure with 13mm Ratchet Clamps.

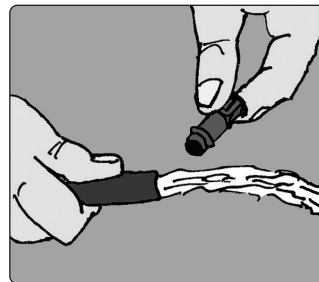

- 2 If the sprinkler coverage is too small, snap off the deflector for wider coverage.
 - 1.6 m diameter (with deflector)
 - 5.0 m diameter (without deflector)

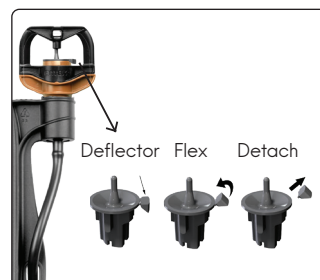

Note: Once deflector is removed it cannot be re-attached.



Performance Chart – Tested at 0.2m above ground

Pressure (kPa)	Flow (lph)	Diameter (m) with deflector	Radius (m) without deflector	Stream Height (m)
175	30	1.6	5.0	0.4

Example Layouts

Circuit Pipework

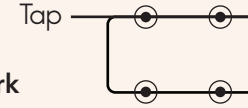

Straight Line Pipework

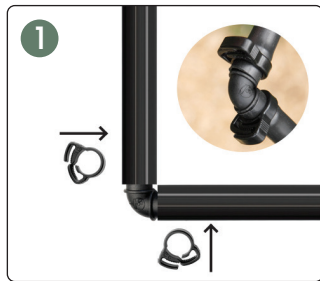
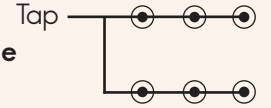

Slide 13mm Ratchet Clamp over Poly Pipe. Then, push barbed fittings into tubing, slide ratchet clamps over joins to secure.

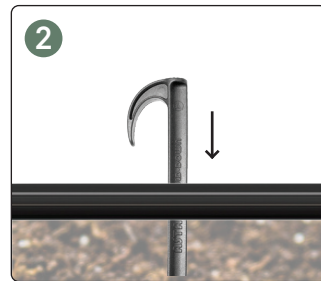

Insert hold-down stakes into the soil to keep the 13mm tubing in place.

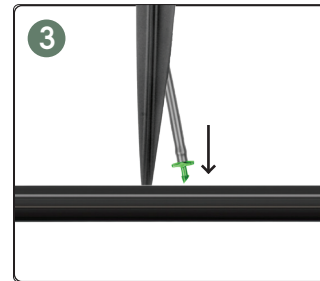

Insert the self-piercing adaptor directly into the 13mm Poly Pipe to install.

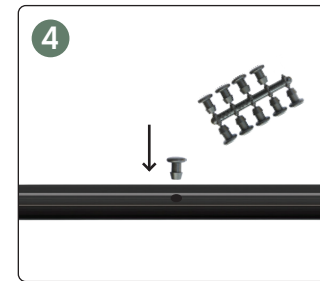

Plug any unwanted holes with Goof Repair Plugs.

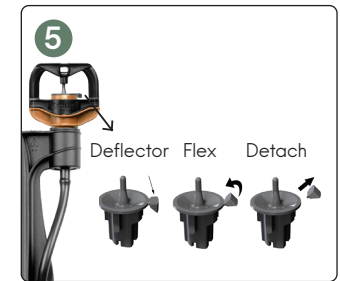

Snap off deflector to achieve wider coverage:

- 1.6m Diameter (with deflector)
- 5.0m Diameter (without deflector).

